



Training Centre Project Proposal

Problem:

Skills training in the rural areas of southwestern Zambia is currently dependent on the assistance of volunteer trainers and the hospitality of local people. Training sessions are very infrequent as the logistics in arranging it are daunting to volunteers: teachers have to ensure that everything they need would be available at the remote site. Local hosting volunteers provide accommodation or camping space for learners, dependent children and teachers. Volunteer teachers provide supplemental funding to the hosting volunteer for the purchasing and preparation of food for the hosting family, students, their dependents, and teachers. The hosts also prepare water and ablution facilities.

The training itself is done outdoors under whatever shelter is available. This may be underneath a tree, piece of canvas or a thatched roof, if fortunate. The church leadership training is delivered in Itezhi-tezhi while normal church and community programs continue, creating disruptive learning conditions.

Finding volunteers who are willing to work and support the training and student participants is not difficult; the problem is arranging accommodation and the facilities in which the training can take place every time, and hauling needed equipment to that site. As people volunteer to support the training program, an environment that is conducive to training and reduce volunteer effort, would greatly contribute to the increase delivery of training courses and thereby benefit the community at large.

Solution:

Having a dedicated accommodation and training facility would allow an expansion of the training courses available. It would mean more courses could be scheduled per given time period and therefore result in a greater positive improvement in the spiritual and socio-economic conditions of the communities and families served.

We are therefore recommending a two phase approach to building a multi-purpose training and residential center. This center would provide a place for church leadership training (The Timothy Leadership Program, and three programs developed by Daniel Mayapi for church leaders) and training in practical skills such as sewing, woodwork and agriculture.

Description of training center:

Phase 1 will consist of accommodation for 18 student participants; 4 trainer teachers; a multi-purpose training classroom and a basic “Tonga” style kitchen. Phase 1 will also include a roofed in space which will serve as a living/dining area.

In addition to the construction necessary, the following equipment will also need to be purchased:

- Generator
- Brick making machine
- Water pump
- Insect netting
- Water storage tank and water filter
- 20 sets of furniture and linen (chairs, beds, mattresses, blankets, pillows, sheets, etc).
- Kitchen utensils

Construction for Phase 1 cannot start until after the rainy season ends in April 2014.

Phase 2 will consist of additional accommodation for student participants; a thatched administration office; a store room; improved kitchen facilities and additional staff accommodation.

Construction is expected to be completed before the end of the calendar year. Phase 2 construction will commence in April 2015.

In addition to the construction necessary, the following equipment will also need to be purchased:

- Projector and screen
- 20 solar lighting and charging panels
- 5 solar water heaters
- Gas stoves
- 14 sets of furniture and linen (chairs, beds, mattresses, blankets, pillows, sheets, etc).

Following is an example of teacher accommodation and classroom:



Following is a sketch of the planned student accommodation: three people per room with shared shower and toilet facilities:

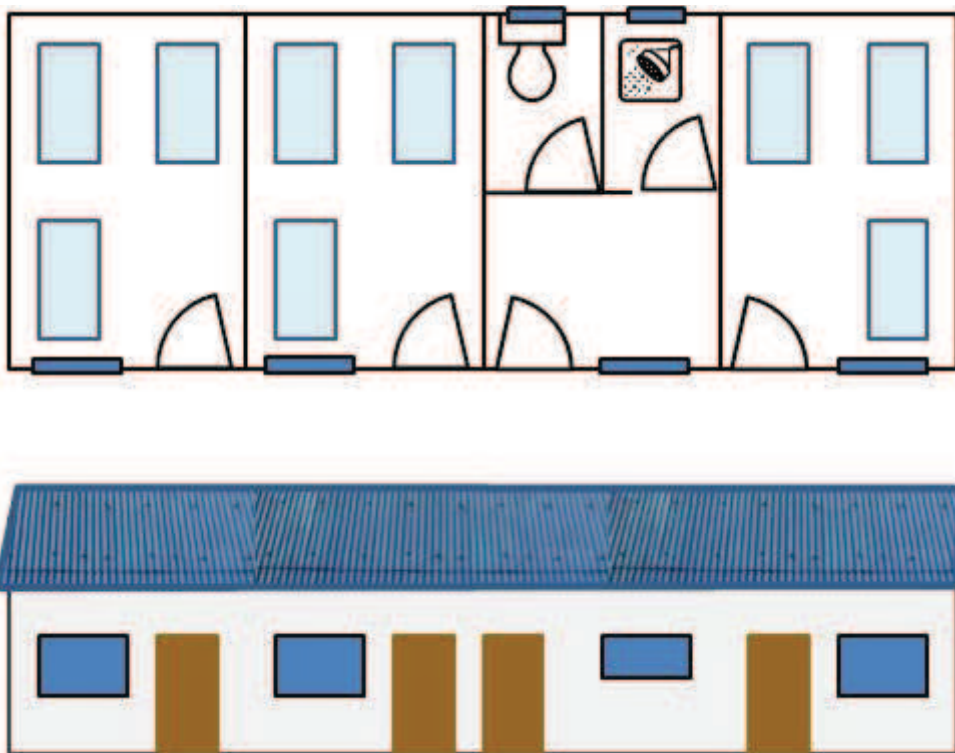

See the sketch of the planned classroom store and dining/living area. It will be a thatched roof:

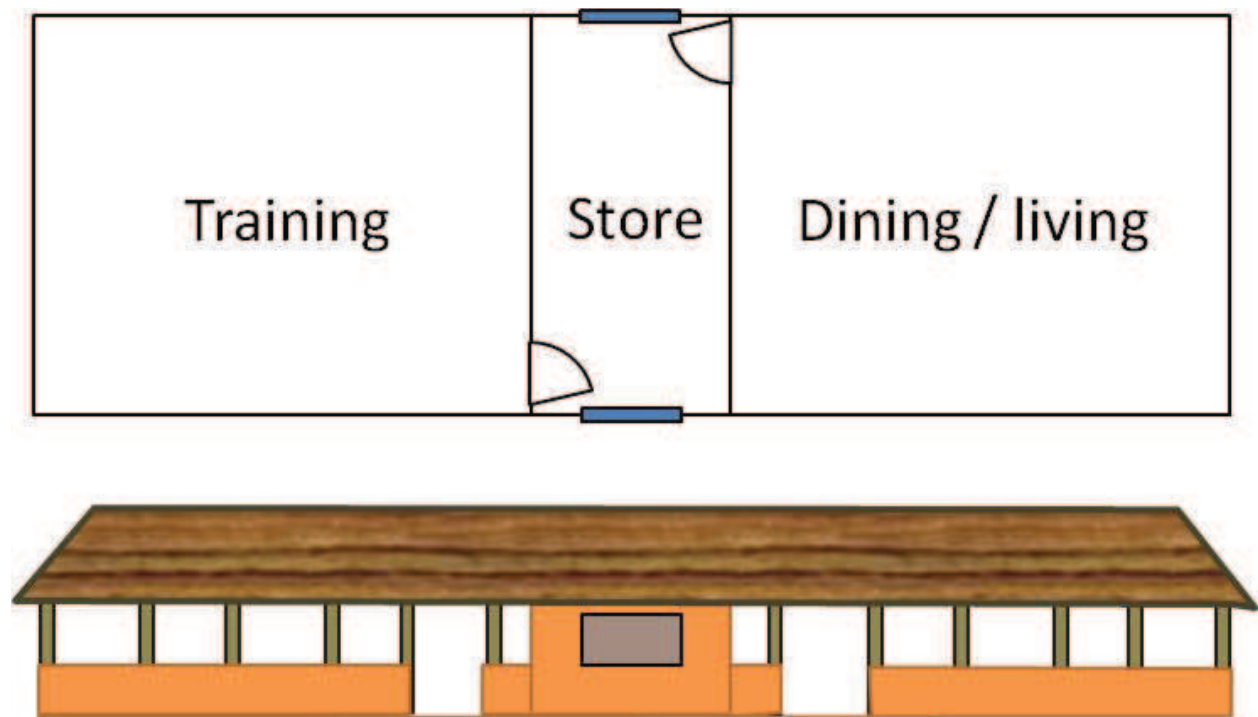

Budget:

The budget has been broken up into two phases, each with a construction budget and an equipment budget.

Summary of costs:

Phase 1

Phase 1 Construction	25,219
Phase 1 Equipment	19,044
Total	44,263

Phase 2

Phase 2 Construction	26,227
Phase 2 Equipment	14,412
Total	40,639

Strategic Funding Plan:

There are four funding thresholds:

April 2014 funding for Phase 1 construction - \$25,219

October 2014 funding for Phase 1 equipment - \$19,044

April 2015 funding for Phase 2 construction - \$25,227

October 2015 funding for Phase 2 equipment - \$14,412

We have approached and are in the end stage of negotiations with a funder for small business loans to be attached to the training programs. This enables successful students to access funds as “short term loans.” The intention is to establish a revolving loan fund.

We have a commitment from the Christian Reformed Church’s World Missions’ group that would like to partner with NLT to fund the Timothy Leadership Institute’s leadership training and the education care program. This program would be available for pastors of NLT churches and other pastors in the area.

We are approaching a large construction company in Itzhi-tezhi who have the contract to build and complete part of the national hydro-electric scheme in Zambia.

We have approached and are in discussion with South African groups who are already involved in supporting on-going training. We hope to expand and extend their commitment to this project. This is the Wonderpark Dutch Reformed Church and the Share Your Knowledge organisation.

Contact information:

Contact International Teams Canada

Lianti Muller, Impact Zambia Canadian Program Leader:

519.955.2444 or Lianti.Muller@iteams.ca

Kim Loney, Chief Program Officer (CPO)

Phone: 519.669.8844 / Toll-Free: 800.465.7601 / Fax: 519.669.5644

Kim.Loney@iteams.ca

Address: 1 Union Street, Elmira, ON, Canada N3B 3J9

Charitable # 12659 9919 RR0001

<http://www.iteams.ca/>

Detailed Costing appendix:

Phase 1	Size (sqm)	Size (sqft)	Thatch roof	Iron sheets	Walls
Student block #1	96	1033		Y	Y
Student block #2	96	1033		Y	Y
Trainer tent #1	30	323	Y		
Trainer tent #2	30	323	Y		
Training room #1	80	861	Y		Half*
Store Room #1	32	344	Y	Y	Y
Dining room	80	861	Y		Half
	444	4779	252	224	
Cost per area:			Sqm	Sqm	

*"Half" refer to walls approx 1m/3ft high that allows light and a breeze for more pleasant working circumstances

Phase 2	Size (sqm)	Size (sqft)	Thatch roof	Iron sheets	Walls
Student block #3	120	1292		Y	Y
Trainer tent #3	30	323	Y		
Kitchen	64	689	Y		Half
Store Room #2	32	344		Y	Y
Admin office	32	344	Y	Y	Y
Staff quarters	96	1033		Y	Y
Training room #2	80	861	Y		Half
	454	4887	206	280	
			Sqm	Sqm	

ITEM	QTY	UNIT PRICE	TOTAL ZMK	TOTAL CAD
Construction (Phase 1) - repeat for Phase 2				
Timber - 50x100	150	ZMK 80.00	ZMK 12,000	\$ 2,330
Timber - 50 x 75	85	ZMK 75.00	ZMK 6,375	\$ 1,238
Wall plates	15	ZMK 80.00	ZMK 1,200	\$ 233
Wood preservative & thinners	1	ZMK 1,000.00	ZMK 1,000	\$ 194
Wire Nails (kg)	40	ZMK 50.00	ZMK 2,000	\$ 388
Roof Nails (kg)	30	ZMK 60.00	ZMK 1,800	\$ 350
Tie Wire (rolls)	8	ZMK 20.00	ZMK 160	\$ 31
Roof sheets (72 - 3.6m; 34 - 2.7m)	106	ZMK 80.00	ZMK 8,480	\$ 1,647
Cement (pockets)	200	ZMK 80.00	ZMK 16,000	\$ 3,107
Windows	14	ZMK 350.00	ZMK 4,900	\$ 951
glass & putty	14	ZMK 100.00	ZMK 1,400	\$ 272
Doors	14	ZMK 350.00	ZMK 4,900	\$ 951
Handles & locks	14	ZMK 35.00	ZMK 490	\$ 95
Varnish (5litre can)	1	ZMK 110.00	ZMK 110	\$ 21
Burglar door	1	ZMK 750.00	ZMK 750	\$ 146
Iron rods for stool room (rebar - est 20ft price)	32	ZMK 43.47	ZMK 1,391	\$ 270
Thatch for roofs (bundles) - assume 8 bundles/s	2,048	ZMK 5.00	ZMK 10,240	\$ 1,988
Labour for Thatch (K1000/9sqmetr)	29	ZMK 1,000.00	ZMK 29,000	\$ 5,631
Transport of materials	4	ZMK 1,000.00	ZMK 4,000	\$ 777
Toilet and cisterns	4	ZMK 500.00	ZMK 2,000	\$ 388
electrical materials (based on ITT church)	1	ZMK 2,200.00	ZMK 2,200	\$ 427
			ZMK 110,396	\$ 21,436

Equipment (phase 1)				
Safari tents for trainers	2	ZMK 18,678.33	ZMK 37,357	\$ 7,254
Brick making machine (to keep for training)	1	ZMK 5,000.00	ZMK 5,000	\$ 971
Generator	1	ZMK 3,500.00	ZMK 3,500	\$ 680
Netting for training centre and dining area (60m	1	ZMK 1,133.00	ZMK 1,133	\$ 220
Piping	1	ZMK 1,000.00	ZMK 1,000	\$ 194
Water Pump	1	ZMK 3,500.00	ZMK 3,500	\$ 680
Water reservoir	1	ZMK 2,500.00	ZMK 2,500	\$ 485
Water filter (Crown Berkey system w 4 filters)	1		ZMK 2,673	\$ 519
Blankets, pillows, sheets, towels	20	ZMK 500.00	ZMK 10,000	\$ 1,942
Kitchen utensils & cutlery	1	ZMK 2,000.00	ZMK 2,000	\$ 388
Single mattresses	20	ZMK 250.00	ZMK 5,000	\$ 971
Wooden beds	20	ZMK 350.00	ZMK 7,000	\$ 1,359
Tables	6	ZMK 200.00	ZMK 1,200	\$ 233
Chairs	20	ZMK 75.00	ZMK 1,500	\$ 291
			ZMK 83,362	\$ 16,187

Equipment (phase 2)				
projector & screen	1	ZMK 3,500.00	ZMK 3,500	\$ 680
Solar lights with cell phone chargers	20	ZMK 225.25	ZMK 4,505	\$ 875
Solar water heaters	5	ZMK 2,461.32	ZMK 12,307	\$ 2,390
Gas stoves	1	ZMK 2,500.00	ZMK 2,500	\$ 485
Safari tent for trainers	1	ZMK 18,678.33	ZMK 18,678	\$ 3,627
Wooden beds	14	ZMK 350.00	ZMK 4,900	\$ 951
Single mattresses	14	ZMK 250.00	ZMK 3,500	\$ 680
Blankets, pillows, sheets, towels	14	ZMK 500.00	ZMK 7,000	\$ 1,359
Water Pump	1	ZMK 3,500.00	ZMK 3,500	\$ 680
Tables	6	ZMK 200.00	ZMK 1,200	\$ 233
Chairs	20	ZMK 75.00	ZMK 1,500	\$ 291
			ZMK 63,090	\$ 12,250