

**GUNJAN & ASSOCIATES**Architects, Engineers, Interiors &  
Landscape Designers,

3/55, Vipul Khand, Gomti Nagar,

Lucknow-226010.

Phone: 2303118, 9839018489, 9838818489

E-Mail: arunjan@yahoo.com

**FURNISHING ESTIMATE FOR THE PROPOSED INTERIORS FOR****GRAMIN BANK OF ARYAWART AT AUSAR ,KANNAUJ BRANCH**

<b>FURNITURE WORK</b>					
<b>S.NO.</b>	<b>DESCRIPTION OF ITEM</b>	<b>QTY.</b>	<b>UNIT</b>	<b>RATE</b>	<b>AMOUNT</b>
<b>1</b>	<b>CASH CABIN PARTITION</b>				
	Cash cabin partition made of both side 6.00 mm commercial ply on kail wood frame section 50x35 mm and 1.00 mm mica, aluminum grill partition and mica laminated aluminum grill door complete with locks, top of cash cabin covered by aluminum grill. Including all locks & handles. Size of cash cabin 5 ft x 7 ft x 8.5 ft, sample cash cabin can be seen at our gomtinagar Branch. Front of the cash Cabin to be glazed with 12 mm thick glass fixed in position by teak wood members complete to the satisfaction of the architect. The cash cabin to have night latches as per direction of the architect. This would also include decorative aluminium jali at the top of cash cabins fixed with teak wood members.	240	Sft		
<b>2</b>	Bank counter of approved design for cashier made of 19.00 mm commercial block board and sunmica 1.00 mm thick of approved brand and colour on front customer top and writing desk. Height of counter from customer side 114 cm (45"). width of writing desk 75 cm. (30") with provision of cupboard after every 1.20 mts made of 19.00 mm block board with 1.0 mm sunmica pasted on both side (inner and outer) , and teakwood beading complete with quality polish finish. Mica pasted on both sides external & internal including all locks & handles. Sample bank counter can be seen at our gomtinagar Branch.	5	Rft		
<b>3</b>	Accounts counter made of 19.00 mm block board with table top at the height 75 cm and 80 cm wide sunmica 1.0 mm on top and cupboard and sliding key board with provision of fixing of glass in front. Mica pasted on both sides external & internal including all locks & handles Sample bank counter can be seen at our Gomtinagar Branch.	5	Rft		
<b>4</b>	12 MM plain glass with rounded edges with etching as per the requirement of bank for Accounts counter (Height: 60 cms) (With teak wood frame 70 cm). Sample bank design can be seen at our Gomtinagar Branch.	10	Sq. ft.		

5	Low Height Partition made of both sides 6.00 mm commercial ply laminated with 1.0 mm sunmica on Cheed Wood frame section 50.00 mmx30.00 mm with glass of 12 mm and door made of 100 x 25 cheed wood frame and ply and mica including all locks, handles & bolt, quality polish etc. Sample bank's low height partition can be seen at our Gomtinagar Branch.	150	Sq. ft.		
6	Counter side partition made of 19.00 mm BB& 1.00 mm mica on both sides of approved colour including all locks handles & bolt etc. Sample bank's counter side partition can be seen at our Gomtinagar Branch.	15	Sq. ft.		
7	Column/ wall Paneling with 12.00 mm board and 1.00 mm mica till 8'-6" height	90	Sq. ft.		
8	Table for Manager size 150x90x75 cm (5'x3'x2½') with sunmica top having 3 drawers on one side and one drawer and one cupboard on the other side made of 19.00 mm board with 1.0 mm sunmica pasted on all sides, lock on all drawers and all cupboards. Mica pasted on both sides external & internal, foot rest with table.	1	No		
9	Officer Table made of 19.00 mm board with sunmica 1.0 mm both sides and front size 135x75x75 (4.5x2.5x2.5) with three drawers on one size and one cupboard and one drawer on the other with lock on all drawers and all cupboards.	0	No		
10	Computer Operator Chair with arms, revolving and P.U. base with twin wheel, casters, upholstered in good quality cloth, foam of high density.	1	No		
11	Office chair revolving with moulded foam seat with P.U. arms and P.U. base, with twin wheel casters upholstered in good quality cloth. foam of high density	2	No		
12	Visitor Chair-without PU Arm and all specification same as to officer chair	3	No		
13	perforated three seated bench of good quality in nickel polish.	2	No		
14	Notice Board made of 19.00 mm board (size: 3'-0"x3'-0") laminated sides and covered by good quality Cherry Colour Velvet with attached Cheque Writing Desk (6"x6"x9") with attached Two Battens for Support, Sunmica Pasted on all sides.	1	No		
15	Suggestion Box made of 19.00 mm board with Size = 1'-6" x 2' Laminated with mica on top, glass in front including godrej lock & brass handle.	1	No		
16	Cheque Drop Box Size = 1'-6" x 2' Laminated with mica on top including godrej lock & brass handle. glass in front	1	No		
17	Cupboard for manager and officer size 4'x1'-6"x2'-6" (120x45x76) with sunmica having 3 drawers & cupboard made of 19.00 mm board with 1.00 mm sunmica pasted on all outer sides & locks on all Drawers & all cupboards	2	No		

18	Aluminum entrance door with window with 8.00 mm float glass (3M frosted sticker ) design with top , bottom and middle section of 45.00mm x 90.00 mm hindilco / jindal with 25.00 micron anodizing along with SS, C shape of kitch or equivalent make along with hardware of hemco / everite make. The item also includes door locks completed to the satisfaction of bank / architect. This would also include Aluminium fixed glazing as per direction of the Architect.	90	Sqft		
19	<b>WRITING DESK AND SUGGESTION COUNTER</b>				
	Writing Counter of 19mm urea bonded board as/ design with 1 mm on 19mm thick Phenol Bonded Commercial Board. The counter to have a notice board at the upper portion and a suggestion counter at the lower portion as per detailed drawing. Vertical Separators for slips to be provided	1	No		
20	<b>Flush Door</b>	2	No		
21	a. Rear Storage /Top Storage cabinets 1'-4" deep of 19mm. Urea bonded block board of approved make laminated with 1mm.thick laminate on sides and the cabinet shutters. The cabinet to have 12mm urea bonded ply at back. With shelves etc. All edges to have TW lipping as/design duly melamine polished. The item included all hardware such as self closing hinges of hettich/kaff, handles, locks etc. The interior of the cabinet to be enamel painted completed to the satisfaction of the architect.	Sq. ft.	55.00		
<b>TOTAL</b>					

**GUNJAN & ASSOCIATES**Architects, Engineers, Interiors &  
Landscape Designers,

3/55, Vipul Khand, Gomti Nagar,

Lucknow-226010.

Phone: 0522-2303118, 9839018489

**E-Mail: arunjan@yahoo.com****LIST OF MATERIALS FOR FURNISHING WORKS****List of Approved Materials**

<b>S. No.</b>	<b>Material</b>	
1	Commercial Board/ Ply Urea Bonded	Corbett, Truwood, duro
2	Laminate	Heritage, Greenlam, Durolam
3	Veneer	Century/Decolam/ Truwood/ Archid
4	Screw(Oxidised)	Gkw/ Nettle Fold
5	Hardware	Earl Bihari / Shalimar
6	Adhesive	Fevicol SH
7	Locks	Godrej
8	Floor Spring/Door Closures	Hyper/ Everite/ Hemco
9	Hinges.Tower Bolts,Handles	Brass Oxidised/ Epoxy Powder Coated (Heavy duty) with Steel Pin
10	Wood and Beadings	Teak Wood, Sal Wood
11	Glass	Modi, Float Glass, Saint Gobain
12	Paints	Nerolac, Berger, Asian, Dulux
13	Ceramic, Vetrified Tiles	Bell, Kajaria, Murudeshwar CeramicsJhonson, Varmora
14	Sanitary Fittings	Hindware, Parryware, Jaguar
15	Aluminium Door and Window Sections	Jindal, Indal and MK
16	Vertical Blinds	Vista, Sun
17	Drawer Channel	Flyrail/ Glydo/ Hettich
18	Soft Board	Cellotex
19	Surface Textures	Spectrum/ Heritage
20	Oil Bound Distemper	Berger Bison, Asian
21	Acrylic Emulsion	Berger Rangoli, Asian
22	Teak Wood	UP Teak
23	Fire Retardant Coating	Viper or Equivalent (Certified by CBRI)

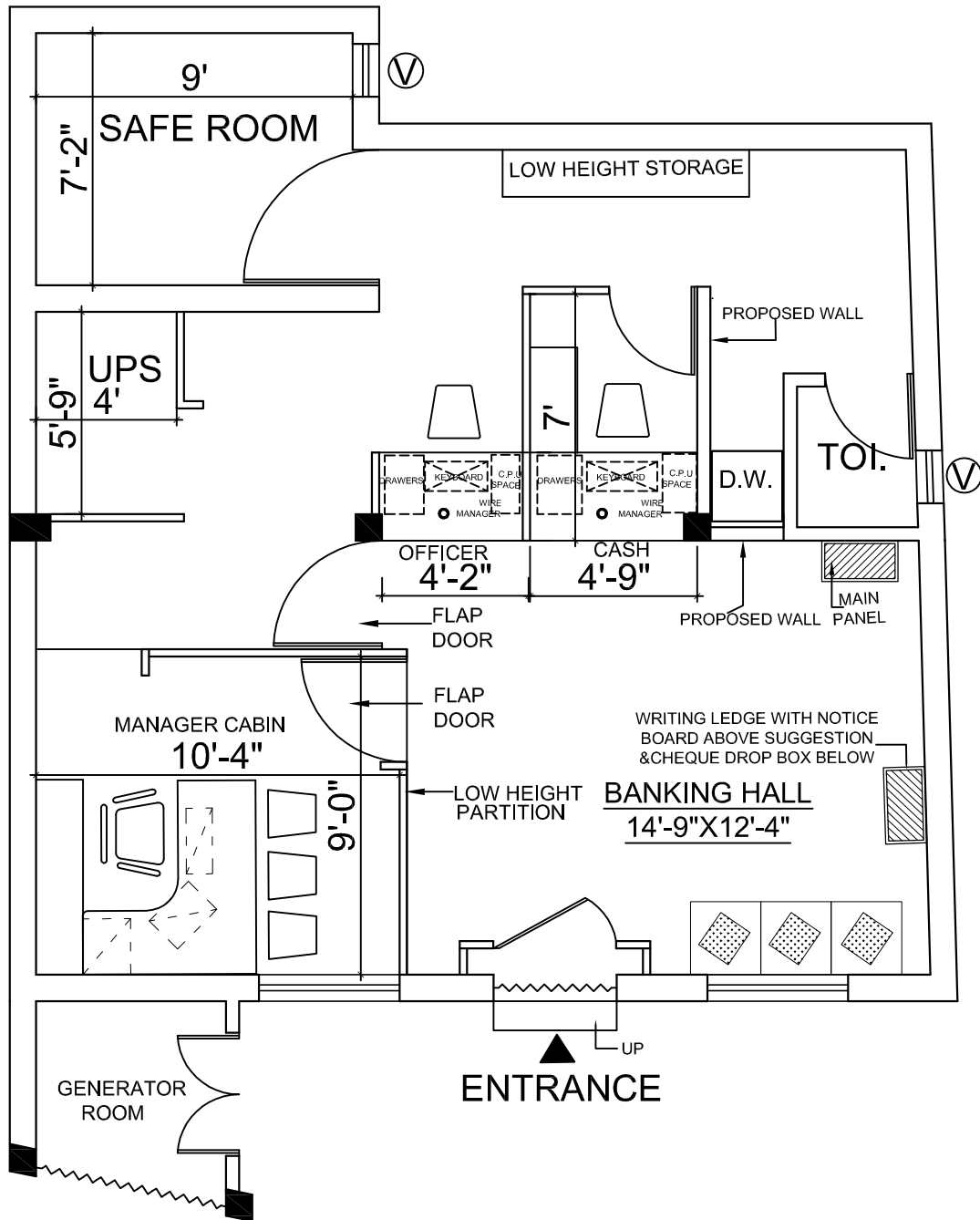

job title

**PROPOSED LAYOUT PLAN OF  
GRAMIN BANK OF ARYAVART  
AT AUSER, KANNAUJ**

Drg. Title

LAYOUT PLAN

Date :-

SEP- 2013

NORTH :-



Chkd. By

**GUNJAN AND ASSOCIATES**

ARCHITECTS, ENGINEERS, INTERIOR  
AND LANDSCAPE DESIGNERS.

3/55, VIPUL KHAND, GOMTI NAGAR,  
LUCKNOW-226010  
Phone: 2303118, 9839018489, 9838818489